

CD-3900

Ultrasonic cleaner

(DENTURE) (JEWELLERY)

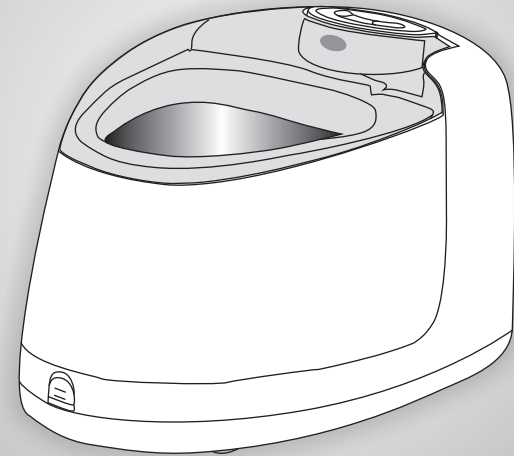

USER GUIDE

⇒ FEATURES:

- **Detachable stainless steel Tank**
More convenient to do the pouring and wiping
- **Ultrasonic Frequency: 42,000Hz**
To make item cleaning more easy and safe only by using tap water
- **Small and delicate**
Suitable for bathroom use

- **Read All Instructions Before Using**
- **Keep This Manual**

INTRODUCTION

Principles of ultrasonic cleaning:

Millions of tiny air bubbles are generated within liquid by high frequency vibration.

The air bubbles burst when in contact with object and dislodge the debris to achieve the cleaning effect.

READ THE MANUAL FIRST

The manual should be carefully reviewed before starting to use the device.

Warnings should be observed carefully. Please follow the manual for operations.

TABLE OF CONTENTS

- 1 Safety Precautions
- 2 Items Not Suitable for Ultrasonic Cleaning
- 3 Dirt elimination processes
- 4 Sample Applications
- 5 Product Structure and Accessories
- 6 Two different ways of cleaning
- 7 Operation Guidelines
- 8 Care and Maintenance
- 9 Specification

SAFETY PRECAUTIONS

⊘ WARNING-To reduce the risk of burns, fire or injury to persons



Do not disassemble the unit except for the authorized technician.



Do not fill the tank with abrasive or corrosive chemicals.

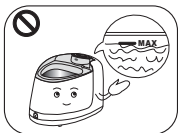

Unplug the unit before filling. Do not exceed the "MAX" mark.

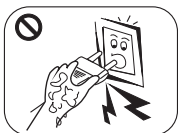

Do not touch the socket with wet hand to avoid electric shock.

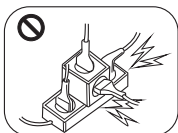

Use the unit properly as per its instruction manual. Do not use attachments not recommended by the manufacturer.

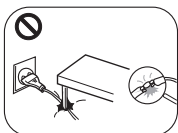

Never operate this unit if cord or plug is damaged. If it is not working properly, damaged or has been dropped into water, return the damaged unit to a service centre for examination and repair.



The Unit is damaged if it works without water.

SAFETY PRECAUTIONS

⚠ DANGER- To reduce the risk of electrocution:

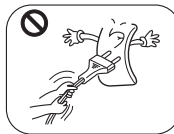

Unplug this unit immediately after using.



Keep the unit and the cord away heated surfaces, and place it on the dry and level surface.



Do not reach for the unit that has fallen into water. Unplug it immediately.



Do not place or store product where it can be pulled into a tub or sink.

⚠ ITEMS NOT SUITABLE FOR ULTRASONIC CLEANING

BIJOUTERIE

Hawkbill, Pearl, emerald, Ivory, Coral, Agate.

Maybe the less rigidity of hawkbill or coral will be scrubbed, color changed or brightness lost caused by the rubbing of one object or surface against another.

PRECIOUS METAL

Soldering metal, electro plating metal, bindings

Be broken off will be happened to the unsolid point of the soldering and binding items by ultrasonic cleaning. The cracked electro plating will be enlarged after cleaning

WATCH

Watch, Pocket watch (Except the waterproof watch under 30m or more)

The water will be in the watch movement of little waterproof function for the ultrasonic strong osmosis occasionally.

OTHERS

Wood, Glass, contact lens, ceramic, camera colored filter.

Maybe rift of ceramic, wooden items, or laminated glasses will be enlarged by ultrasonic cleaning. (It won't be happened for the item in perfect condition).

DIRT ELIMINATION PROCESSES

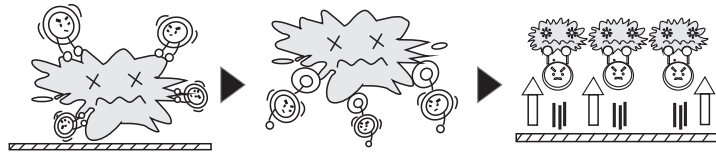



Many tiny bubbles are created when ultrasonic sound is passed through liquid.

Bubble are imploded constantly under the ultrasonic.

The dirt splits into tinys and separate from the item to create cleaning result

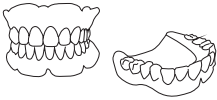
SAMPLE APPLICATIONS

Denture	Jewelry
 <p>Denture</p>	 <p>Ring/earring/Necklace/Bracelet</p>
<p> The denture and Jewellery can get a good clean result but please make sure that the stainless steel tank is clean to avoid any contamination .</p>	

FEATURES AND ACCESSORIES

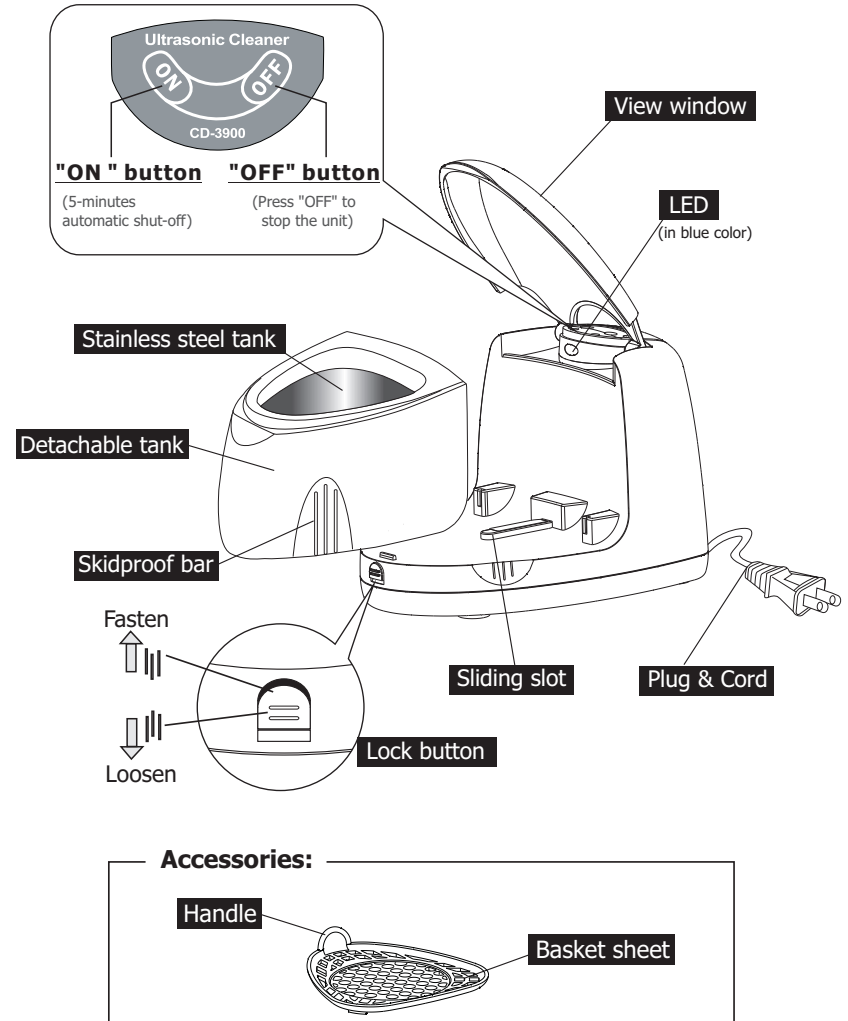

TWO DIFFERENT WAYS OF CLEANING



1 General cleaning

Use only plain water, Ensure the "MAX" marking is not exceeded when immersing the item.

Advantage of Cleaning Dentures

- (1) No much labour needed (just 5 minutes)
- (2) Remove the remains on the denture and will not provide the condition of bringing germ
- (3) Cigarette and tea stains will be removed and dentures will look like new again.



2 Enhanced cleaning

If the item needs deep cleaning, then add a drop or two (3-5ml) of liquid soap into the water. Soap will enhance the "dirt softening action" to enhance the cleaning result.

OPERATING GUIDELINES



1

Open the lid to make sure the stainless steel tank is clean before using. If not, press down the button to unlock the tank. Pull the tank out to clean as shown in the picture.

⚠ Please make sure the stainless steel tank is cleaned before using.



2

After cleaning the stainless steel tank, please pour the water away from the cut.

⚠ Please note no water can be stayed between the stainless steel tank and main body.



3

As picture shows, please push the detachable tank back and close well.

⚠ It is easy to push the detachable tank through the sliding bar in the main body. If difficult, please check your operation.

OPERATING GUIDELINES

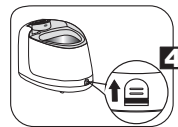

4

Move the lock button up till closed.

⚠ If the detachable tank is not in the right position, you will find that when you press the "ON" button, the unit does not work. This is caused by the safety switch not having complete connection with the detachable tank. If this happens, reattach the detachable tank.

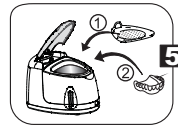

5

Put the item (denture) on the basket sheet to protect the friction between the denture and stainless steel tank.



6

Fill the stainless steel tank with plain water. Ensure the "MAX" marking is not exceeded when immersing the item.

⚠ The Unit is damaged if it works without water.



7

Plug the unit in and close the lid.

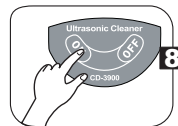

8

Press "ON" button to start cleaning. The blue operation LED will illuminate while the unit will "Buzz" which is normal. The cleaner will turn off after 5 minutes automatically. Should more than one cleaning be needed, just press "ON" again.

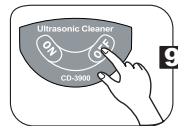

9

If required, you can stop the cleaning process by pressing the "OFF" button. Meanwhile the LED is turned off.



10

When cleaning is finished, unplug the unit and open the lid to take the item out as well as the basket sheet.

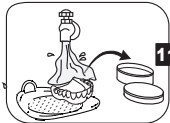

11 Rinse the basket sheet and your dentures with tap water after cleaning. Dentures can now be placed into your denture box.

If required to be cleaned with disinfectant for the denture, please do it as your per your doctor's advice.



12 Move the lock button, pull out the tank, clean it with tap water and wipe dry with a clean dry cloth.

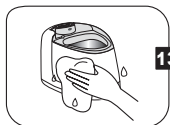

13 Finally, put the detachable tank back and move up the lock button. Wipe dry for next use.

CARE AND MAINTENANCE

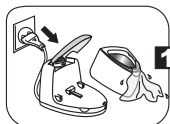

1 After use, unplug and pour away the water in the stainless steel tank.

Water should not remain in the tank after use. Remove water after each use.



2 5 minutes interval or more is recommended for each use thus will increase the life of the unit.



3 Wipe the unit with a clean dry cloth. Do not use chemicals to clean your unit.

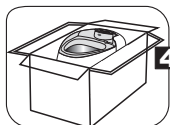

4 The unit should be stored in a cool dry place

SPECIFICATION

DESCRIPTION:	Ultrasonic cleaner (Denture, Jewelry)
ITEM NO.:	CD-3900
POWER SUPPLY:	20W (AC 100V 50/60 Hz) 20W (AC 100~120V 50/60Hz) 21W (AC 220~240V 50/60Hz)
UNIT SIZE :	178 X 120 X 120 MM
TANK CAPACITY (MAX-):	140 ML
TIMER SETTING :	5 Minutes
ACCESSORY:	(1) 1 pc of basket sheet
	(2) 1 pc of User guide